



6FM17 (12V17.0Ah)

6FM17 is a general purpose battery with 3~ 5 years in standby service or more than 260 cycles at 100% D.O.D In cycle service. As with all QiangJun batteries, all FM models are rechargeable, highly efficient, leak proof and maintenance free.



Specification

Cells Per Unit	6
Voltage Per Unit	12
Capacity	17.0Ah@ 20hr-rate to 1.75V per cell @ 25°C
Weight	Approx. 5.2 Kg
Max. Discharge Current	170 A (5 sec)
Internal Resistance	Approx. 14 m
Operating Temperature Range	Discharge: -20°C~60°C Charge: 0°C~50°C St orage: -20°C~60°C
Normal Operating Temperature Range	25°C±5°C
Float charging Voltage	13.6 to 13.8 VDC/unit Average at 25°C
Recommended Maximum Charging Current Limit	5.1 A
Equalization and Cycle Service	14.4 to 15.0 VDC/unit Average at 25°C
Self Discharge	QiangJun batteries can be stored for more than 6 month at 25°C. Please charge batteries before using. For higher temperature, the time interval will be shorter.
Terminal	Terminal F3/F13
Container Material	A.B.S. (UL94-HB) Flammability resistance of UL94-V2 can be available upon request.



Dimensions

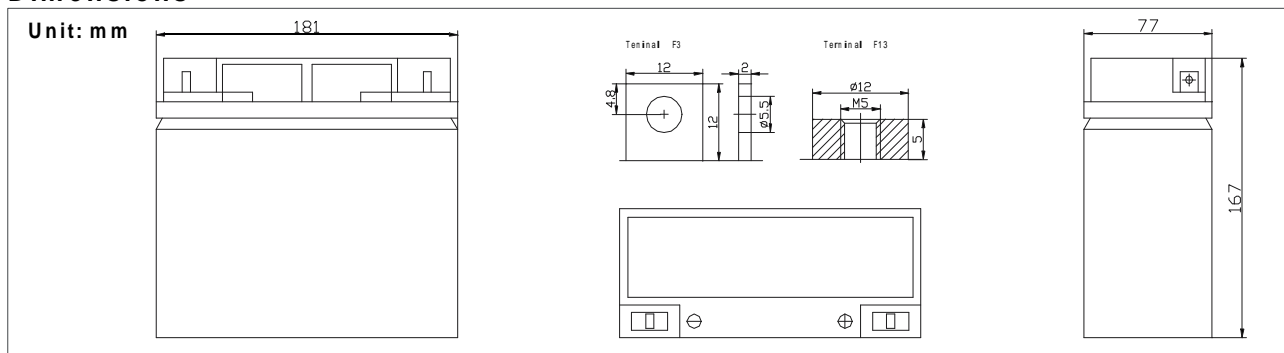

Constant Current Discharge Characteristics Unit: A(25°C)

F.V/Time	5MIN	10MIN	15MIN		1HR	2HR	3HR	4HR	5HR	8HR	10HR	20HR
1.60V	70.6	47.2	36.3	19.9	11.8	7.07	4.35	3.57	2.87	2.11	1.67	0.94
1.67V	66.0	44.0	34.1	19.6	11.7	7.02	4.34	3.55	2.86	2.11	1.65	0.90
1.70V	62.5	42.7	33.3	19.5	11.6	7.00	4.32	3.54	2.84	2.11	1.63	0.88
1.75V	56.4	39.9	31.6	19.0	11.5	6.92	4.30	3.52	2.82	2.11	1.62	0.85
1.80V	50.4	37.2	29.8	18.6	11.3	6.80	4.27	3.50	2.81	2.09	1.58	0.82
1.85V	44.4	34.5	28.1	18.1	11.2	6.70	4.23	3.49	2.79	2.09	1.56	0.80

Constant Power Discharge Characteristics Unit: W(25°C)

F.V/Time	5MIN	10MIN	15MIN	30MIN	1HR	2HR	3HR	4HR	5HR	8HR	10HR	20HR
1.60V	136.00	88.40	71.83	39.88	23.58	14.13	8.69	7.11	6.75	4.23	3.32	1.85
1.67V	127.50	85.00	68.15	39.24	23.51	14.04	8.67	7.09	6.70	4.23	3.28	1.79
1.70V	124.95	82.45	66.59	38.98	23.46	14.01	8.65	7.09	6.68	4.20	3.25	1.75
1.75V	112.91	79.05	63.12	38.05	23.07	13.79	8.60	7.04	6.66	4.18	3.21	1.68
1.80V	100.86	73.95	59.64	37.15	22.68	13.60	8.53	6.99	6.65	4.17	3.16	1.63
1.85V	88.83	68.85	56.17	36.24	22.29	13.40	8.47	6.94	6.63	4.17	3.11	1.58

All mentioned values are average values.

6FM17

12V17.0Ah



Temperature effects curve

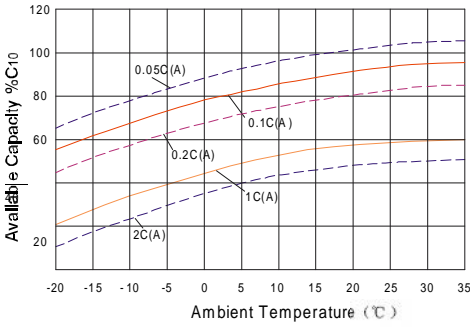

Storage characteristic

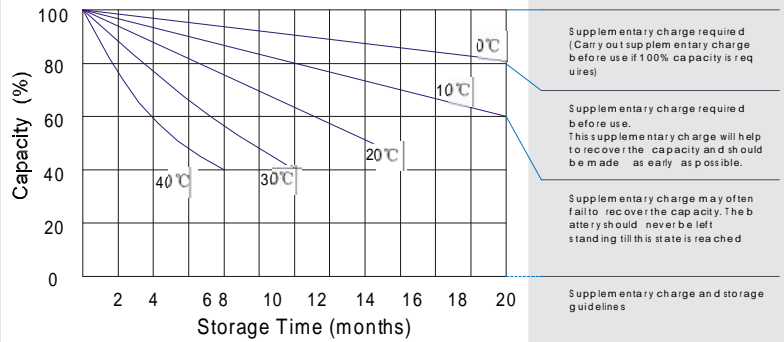

Life characteristics of cyclic use

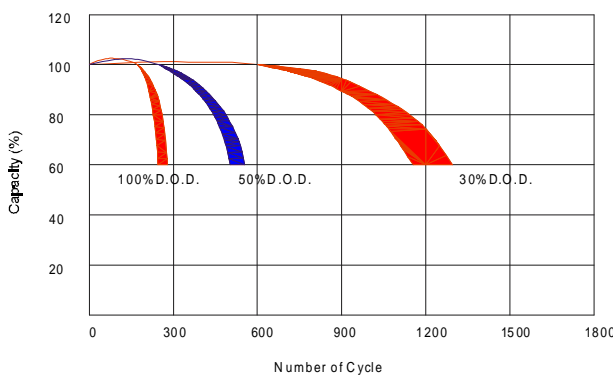

Effect of temperature on long term float life

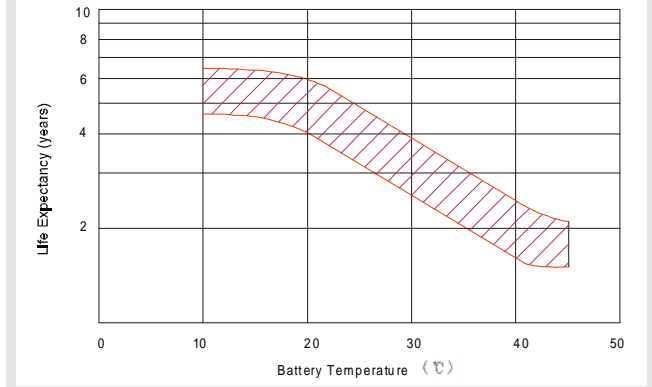

Charge characteristic curve for standby use

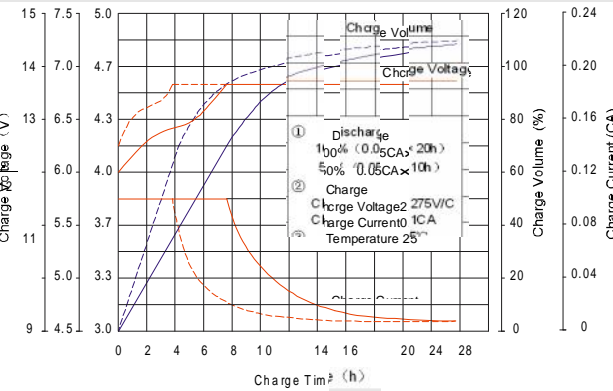

Discharge characteristic curve

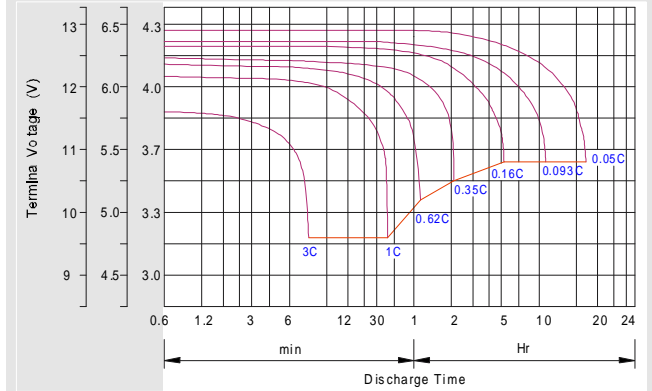

Charging Procedures

Application	Charge Voltage (V)			Max. Charge Current
	Temperature	Set point	Allowable range	
Cycle Use	25°C	14.7	14.4~15.0	0.3C
Standby	25°C	13.7	13.6~13.8	0.3C

Discharge Current VS. Discharge Voltage

Final Discharge Voltage V/cell	1.75V	1.70V	1.60V
Discharge Current (A)	(A) ≤ 0.2C	0.2C < (A) <	(A) ≥ 1.0C

Charge the batteries at least once every six months, if they are stored at 25°C.

Charging Method:

Constant Voltage	-0.2Cx2h +14.4~15.0V,24h,Max. Current 0.3CA
Constant Current	-0.2Cx2h +0.1CAx12h
Fast	-0.2Cx2h +0.3CAx4h

Charging Procedures(6V series)

Application	Charge Voltage (V)			Max. Charge Current
	Temperature	Set point	Allowable range	
Cycle Use	25°C	7.35	7.25~7.45	0.3C
Standby	25°C	6.85	6.8~6.9	0.3C

QIANGJING BATTERY CO.,LTD
 Mudan Road Xiacheng Town,
 Yuefang Distrct,
 Xiangtan City, Hunan P.R.China